

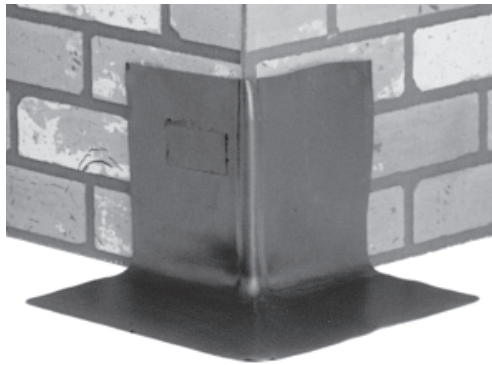

Premolded Corners

Technical Product Information

Pre-manufactured inside & outside corners for all roof systems



**Outside
Corner**

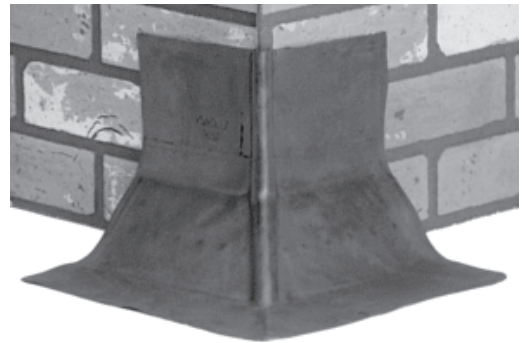

**Outside
Corner
With Cant**

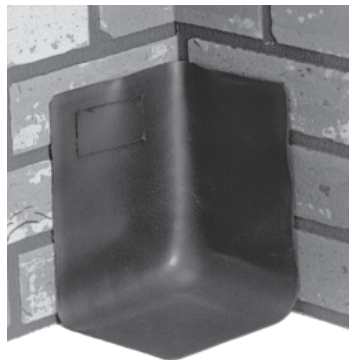

**Inside
Corner**

**Prefabricated Roof Accessories for
All Roof Systems**



Premolded Corners

Technical Product Information

Pre-manufactured inside & outside corners for all roof systems

Outside corners provide a guaranteed, uniform, permanent corner seal. Portals Plus Corners eliminate the cutting, folding, stretching and cementing of materials into unnatural shapes. The Outside Corners have expansion radii molded into the spine to accommodate construction irregularities. All edges on Portals Plus Corners are feathered to allow the best possible adhesion. Outside Corners are available with or without cant and are the true answer to flashing roof curbs and skylight corners.

Inside Corners simplify the difficult detail of terminating roofing materials at corners. All Portals Plus Premolded Corners have seamless molded construction and are essential to a leak-free roof. The flexibility of the unit allows for a secure seal. Reduce the high cost of installation and the even higher cost of callbacks by using Premolded Corners. Fast, positive, watertight corner details are important for preventing costly leaks. 85% of all roof leaks occur at corners or penetrations. Quality flashing accessories are the solution to these costly and damaging leak problems.



Outside Corner

Inside Corner

Outside Corner with cant

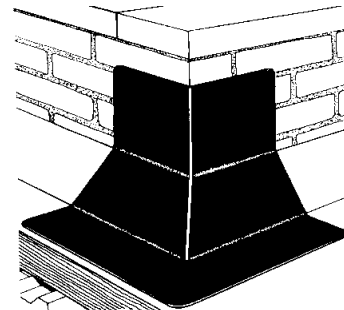
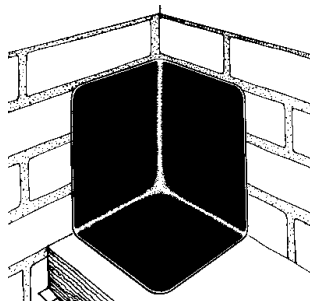
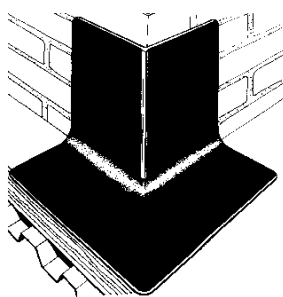



Premolded Corners

Technical Product Information

Outside Corner- EPDM or Neoprene

SPECIFICATION

Furnish and install Premolded Corners as manufactured by Portals Plus, Inc., Bensenville, IL, at all roof corners including parapet walls, architectural and mechanical openings such as skylights, heat and smoke hatches, exhaust fans, fresh air intakes or exhaust hoods, roof top furnaces and condensers, and as specified on drawings. Premolded Corners shall be 8" high with 6" legs and have radius corners and all edges feathered for good adhesion. They shall be injection molded of .060" thick EPDM (Ethylene Propylene Diene Monomer) for use with single-ply rubber roofs or Neoprene for use with hot applied built-up roofs. All Corners shall have a serviceable temperature range of -60 F to +270 F, and be ozone and ultraviolet resistant. They shall be adhered to the roof as per roofing manufacturer's recommended specification.

Roof systems that do not have built-in or field fabricated cant strip shall use Portals Plus Premolded Inside and Outside Corners without cant.

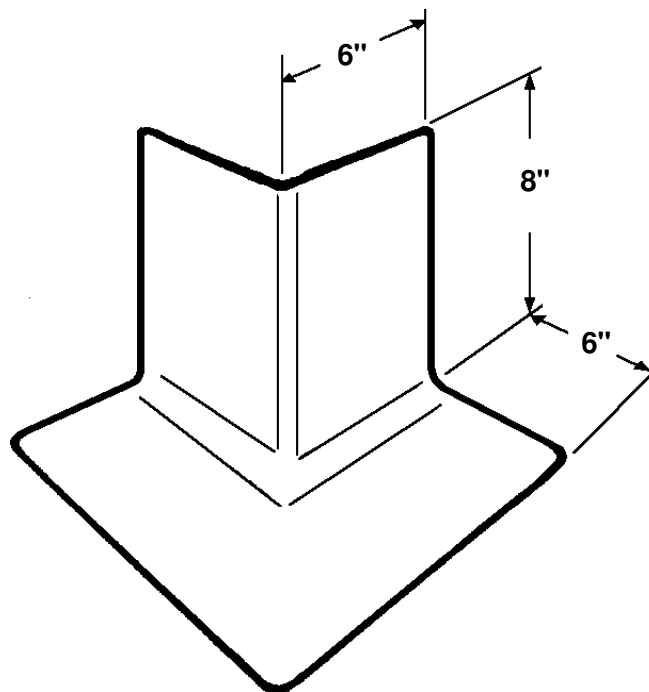
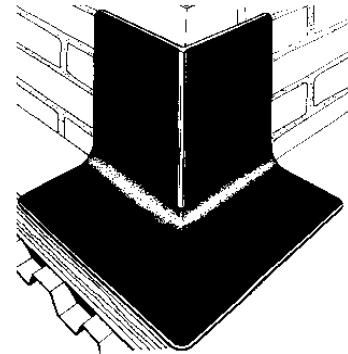



Premolded Corners

Technical Product Information

Outside Corner with cant- EPDM or Neoprene

SPECIFICATION

Furnish and install Premolded Corners as manufactured by Portals Plus, Inc., Bensenville, IL, at all roof corners including parapet walls, architectural and mechanical openings such as skylights, heat and smoke hatches, exhaust fans, fresh air intakes or exhaust hoods, roof top furnaces and condensers, and as specified on drawings.

Premolded Corners shall be 8" high with 6" legs and have radius corners and all edges feathered for good adhesion. They shall be injection molded of .060" thick EPDM (Ethylene Propylene Diene Monomer) for use with single-ply rubber roofs or Neoprene for use with hot applied built-up roofs. All Corners shall have a serviceable temperature range of -60 F to +270 F, and be ozone and ultraviolet resistant. They shall be adhered to the roof as per roofing manufacturer's recommended specification. Roof systems that do not have built-in or field fabricated cant strip shall use Portals Plus Premolded Inside and Outside Corners without cant.

Roof systems that have built-in cant strips shall use Portals Plus Premolded Outside Corners with cant.

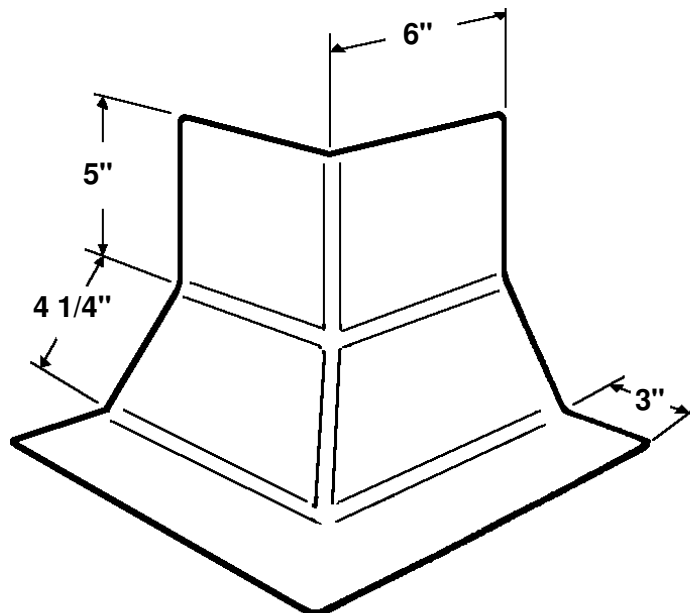
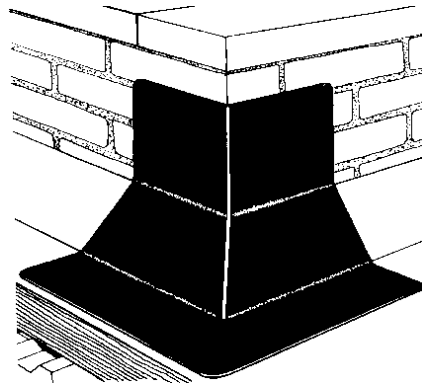



Premolded Corners

Technical Product Information

Inside Corner- EPDM or Neoprene

SPECIFICATION

Furnish and install Premolded Corners as manufactured by Portals Plus, Inc., Bensenville, IL, at all roof corners including parapet walls, architectural and mechanical openings such as skylights, heat and smoke hatches, exhaust fans, fresh air intakes or exhaust hoods, roof top furnaces and condensers, and as specified on drawings.

Premolded Corners shall be 8" high with 6" legs and have radius corners and all edges feathered for good adhesion. They shall be injection molded of .060" thick EPDM (Ethylene Propylene Diene Monomer) for use with single-ply rubber roofs or Neoprene for use with hot applied built-up roofs. All Corners shall have a serviceable temperature range of -60 F to +270 F, and be ozone and ultraviolet resistant. They shall be adhered to the roof as per roofing manufacturer's recommended specification. Roof systems that do not have built-in or field fabricated cant strip shall use Portals Plus Premolded Inside and Outside Corners without cant.

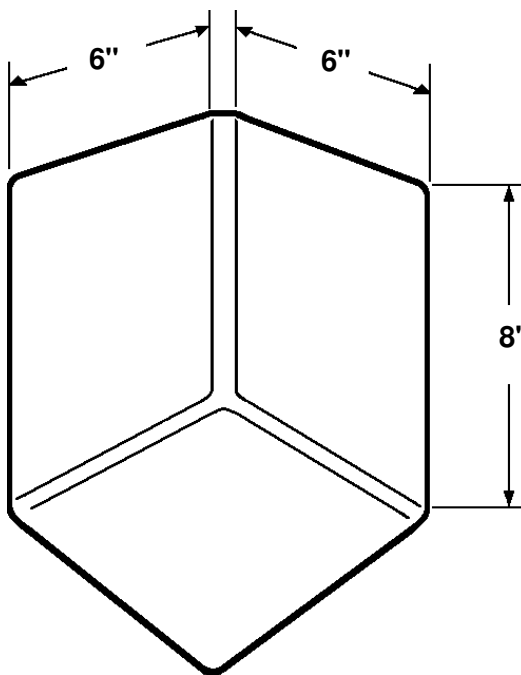
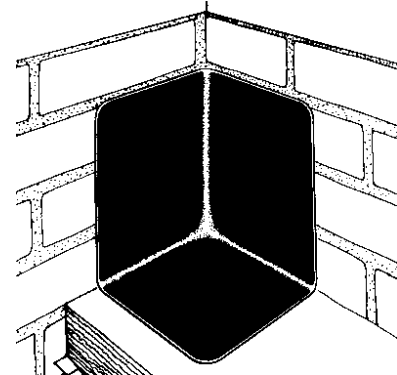



Premolded Corners

Technical Product Information

Combination Inside and Outside Corner- PVC or TPO

SPECIFICATION

Furnish and install Premolded Corners as manufactured by Portals Plus, Inc., Bensenville, IL, at all roof corners including parapet walls, architectural and mechanical openings such as skylights, heat and smoke hatches, exhaust fans, fresh air intakes or exhaust hoods, roof top furnaces and condensers, and as specified on drawings. Premolded Corners shall be 3" high with 6" flange and have radius corners. They shall be injection molded of .060" thick PVC or TPO for use with single-ply PVC or TPO roofs. Use Portals Plus standard colors as necessary. They shall be adhered to the roof as per roofing manufacturer's recommended specification. Roof systems must not have built-in or field fabricated cant strip.

Each Combination Corner molding can be cut into one Inside or Outside Corner.

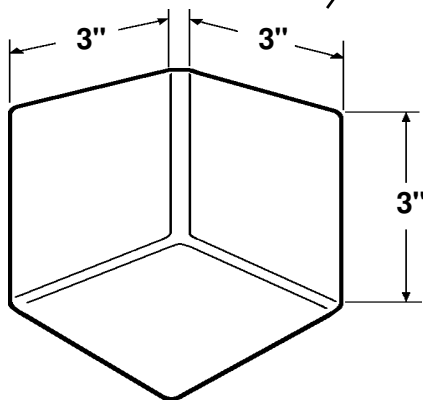

Inside Corner

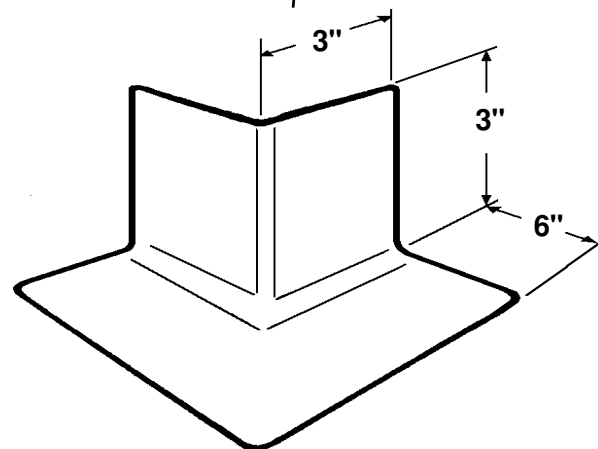

Outside Corner



Premolded Corners

Technical Product Information

Installation Instructions

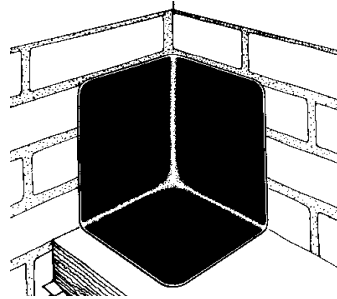
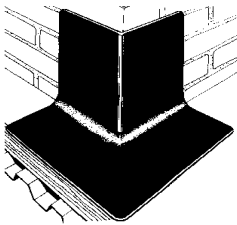
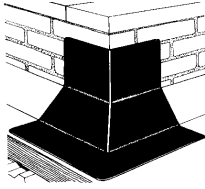

STEP 1

Determine which corner is appropriate. Clean and prime in accordance with roof manufacturer's recommendations.

Portals Plus manufactures Inside and Outside corners in Neoprene, EPDM, PVC, and TPO. These corners can be used for a wide variety of roofing membranes.

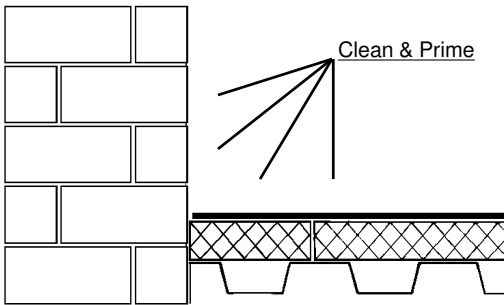

STEP 2

Insure that all substrate surfaces are cleaned and free of dirt and debris.

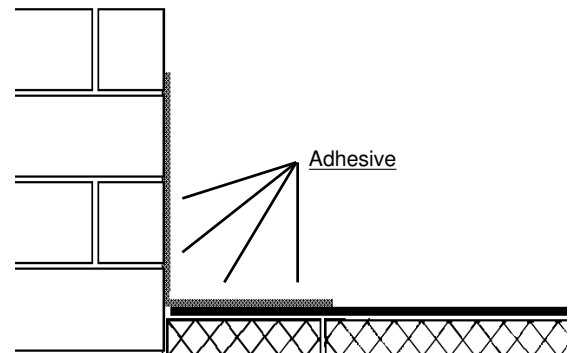

STEP 3- EPDM and Neoprene Corners only

Apply Roofing Manufacturer's recommended adhesive (hot asphalt or glue) to all surfaces to be in contact with corner. Apply same to corner material.

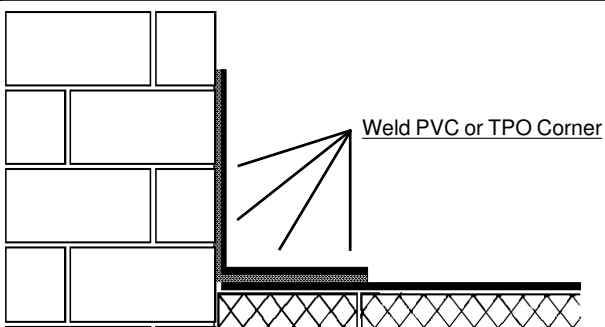

STEP 4

Install corner. Care should be taken to ensure corner does not bridge or wrinkle during installation. Corner must completely conform to the substrate with which it is being bonded.

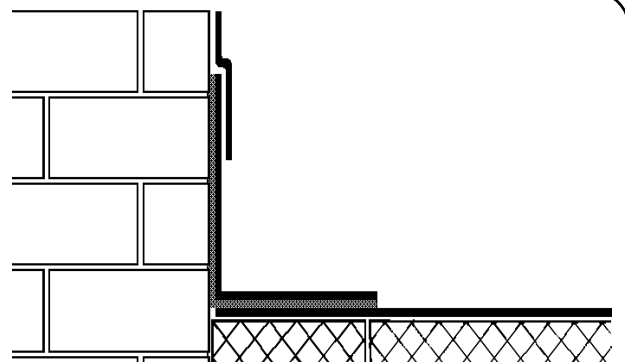

STEP 5

Finish installation per Roofing Manufacturer's recommendations or requirements.