

WARD CONNECTOR

CLT

C Cleat and F Cleat FOR USE WITH TRANSVERSE DUCT FLANGE

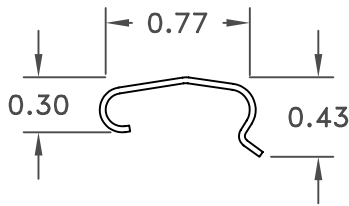

C Cleat (Metal)

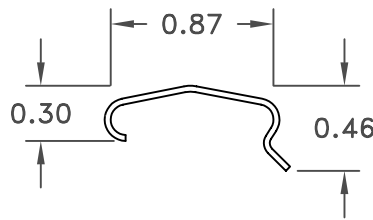

F Cleat (Metal)

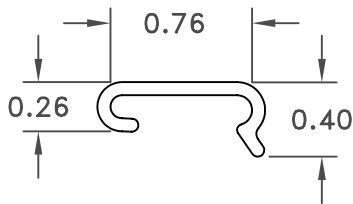

C Cleat (PVC)

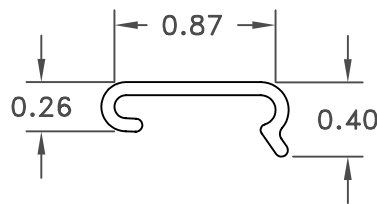

F Cleat (PVC)

SPECIFICATIONS:

1. Rollformed 20 gauge metal cleat
2. Extruded .070" PVC cleat
3. Low temp rating for PVC cleats is 0° F or -17° C

NOTES:

1. C cleat is ideal for securing J, H and E flanges, as well as TDC flanges.
2. F cleat is ideal for securing TDF flanges.
3. Available in the following materials:
 - Galvanized
 - Galvaneal
 - Aluminized
 - Stainless Steel
 - PVC
4. PVC cleat available in 6" lengths. Metal cleat available in 6" or 10' lengths. Contact factory for custom lengths.

JOB NAME: _____	SUBMITTED BY: _____
LOCATION: _____	
ARCHITECT: _____	
ENGINEER: _____	
CONTRACTOR: _____	



500 E. Eighth Street • Holland, MI 49423
T (800) 466-9374 • F (866) 466-9335 • www.wardind.com